

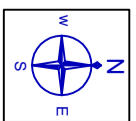

**SONIPAT GLOBAL
INDUSTRIAL TOWNSHIP**

LAYOUT PLAN OF THE INDUSTRIAL PLOTTED COLONY OVER AN AREA MEASURING 32.14375 ACRES IN VILLAGE DEORU & JAWAHRI TEH. & DISTT. SONIPAT (HARYANA), BELONGS TO M/S SYSCOM EDUTECH PVT. LTD.



LEGEND

- ESS = ELECTRIC SUB STATION
- S.T.P. = SEWAGE TREATMENT PLANT
- GREEN / OPEN SPACES
- KILALINE
- SCHEME BOUNDARY
- REVENUE RASTA
- ROAD

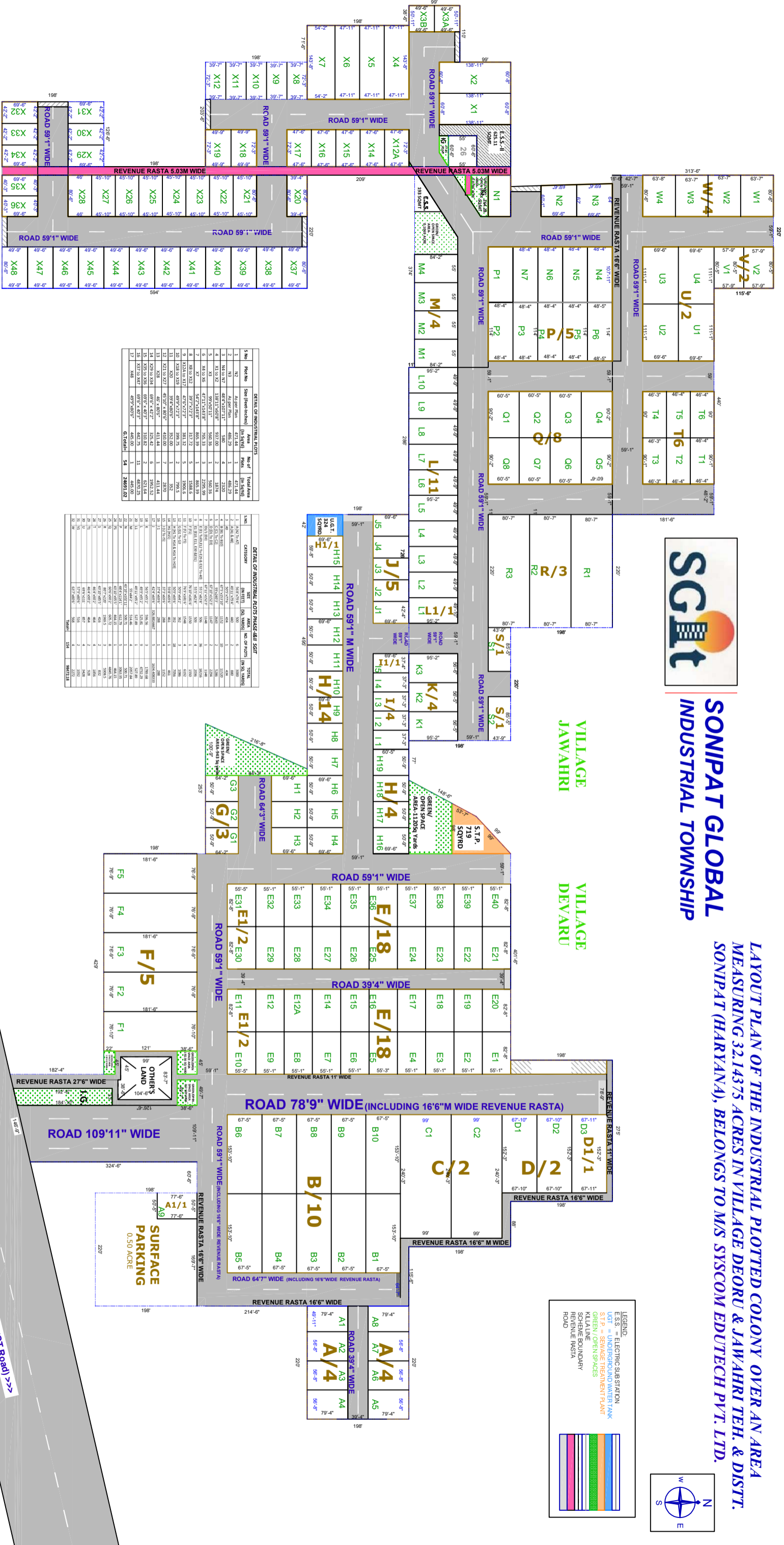

DETAIL OF INDUSTRIAL PLOTS

Plot No.	Plot Size (feet-inches)	Area (sq.ft)	No. of Plots	Total Area (sq.ft)
1	48' x 120'	5760	1	5760
2	48' x 120'	5760	1	5760
3	48' x 120'	5760	1	5760
4	48' x 120'	5760	1	5760
5	48' x 120'	5760	1	5760
6	48' x 120'	5760	1	5760
7	48' x 120'	5760	1	5760
8	48' x 120'	5760	1	5760
9	48' x 120'	5760	1	5760
10	48' x 120'	5760	1	5760
11	48' x 120'	5760	1	5760
12	48' x 120'	5760	1	5760
13	48' x 120'	5760	1	5760
14	48' x 120'	5760	1	5760
15	48' x 120'	5760	1	5760
16	48' x 120'	5760	1	5760
17	48' x 120'	5760	1	5760
18	48' x 120'	5760	1	5760
19	48' x 120'	5760	1	5760
20	48' x 120'	5760	1	5760
21	48' x 120'	5760	1	5760
22	48' x 120'	5760	1	5760
23	48' x 120'	5760	1	5760
24	48' x 120'	5760	1	5760
25	48' x 120'	5760	1	5760
26	48' x 120'	5760	1	5760
27	48' x 120'	5760	1	5760
28	48' x 120'	5760	1	5760
29	48' x 120'	5760	1	5760
30	48' x 120'	5760	1	5760
31	48' x 120'	5760	1	5760
32	48' x 120'	5760	1	5760
33	48' x 120'	5760	1	5760
34	48' x 120'	5760	1	5760
35	48' x 120'	5760	1	5760
36	48' x 120'	5760	1	5760
37	48' x 120'	5760	1	5760
38	48' x 120'	5760	1	5760
39	48' x 120'	5760	1	5760
40	48' x 120'	5760	1	5760
41	48' x 120'	5760	1	5760
42	48' x 120'	5760	1	5760
43	48' x 120'	5760	1	5760
44	48' x 120'	5760	1	5760
45	48' x 120'	5760	1	5760
46	48' x 120'	5760	1	5760
47	48' x 120'	5760	1	5760
48	48' x 120'	5760	1	5760
49	48' x 120'	5760	1	5760
50	48' x 120'	5760	1	5760
51	48' x 120'	5760	1	5760
52	48' x 120'	5760	1	5760
53	48' x 120'	5760	1	5760
54	48' x 120'	5760	1	5760
55	48' x 120'	5760	1	5760
56	48' x 120'	5760	1	5760
57	48' x 120'	5760	1	5760
58	48' x 120'	5760	1	5760
59	48' x 120'	5760	1	5760
60	48' x 120'	5760	1	5760
61	48' x 120'	5760	1	5760
62	48' x 120'	5760	1	5760
63	48' x 120'	5760	1	5760
64	48' x 120'	5760	1	5760
65	48' x 120'	5760	1	5760
66	48' x 120'	5760	1	5760
67	48' x 120'	5760	1	5760
68	48' x 120'	5760	1	5760
69	48' x 120'	5760	1	5760
70	48' x 120'	5760	1	5760
71	48' x 120'	5760	1	5760
72	48' x 120'	5760	1	5760
73	48' x 120'	5760	1	5760
74	48' x 120'	5760	1	5760
75	48' x 120'	5760	1	5760
76	48' x 120'	5760	1	5760
77	48' x 120'	5760	1	5760
78	48' x 120'	5760	1	5760
79	48' x 120'	5760	1	5760
80	48' x 120'	5760	1	5760
81	48' x 120'	5760	1	5760
82	48' x 120'	5760	1	5760
83	48' x 120'	5760	1	5760
84	48' x 120'	5760	1	5760
85	48' x 120'	5760	1	5760
86	48' x 120'	5760	1	5760
87	48' x 120'	5760	1	5760
88	48' x 120'	5760	1	5760
89	48' x 120'	5760	1	5760
90	48' x 120'	5760	1	5760
91	48' x 120'	5760	1	5760
92	48' x 120'	5760	1	5760
93	48' x 120'	5760	1	5760
94	48' x 120'	5760	1	5760
95	48' x 120'	5760	1	5760
96	48' x 120'	5760	1	5760
97	48' x 120'	5760	1	5760
98	48' x 120'	5760	1	5760
99	48' x 120'	5760	1	5760
100	48' x 120'	5760	1	5760

DETAIL OF INDUSTRIAL PLOTS PHASE-1 & 2

Plot No.	Plot Size (feet-inches)	Area (sq.ft)	No. of Plots	Total Area (sq.ft)
1	48' x 120'	5760	1	5760
2	48' x 120'	5760	1	5760
3	48' x 120'	5760	1	5760
4	48' x 120'	5760	1	5760
5	48' x 120'	5760	1	5760
6	48' x 120'	5760	1	5760
7	48' x 120'	5760	1	5760
8	48' x 120'	5760	1	5760
9	48' x 120'	5760	1	5760
10	48' x 120'	5760	1	5760
11	48' x 120'	5760	1	5760
12	48' x 120'	5760	1	5760
13	48' x 120'	5760	1	5760
14	48' x 120'	5760	1	5760
15	48' x 120'	5760	1	5760
16	48' x 120'	5760	1	5760
17	48' x 120'	5760	1	5760
18	48' x 120'	5760	1	5760
19	48' x 120'	5760	1	5760
20	48' x 120'	5760	1	5760
21	48' x 120'	5760	1	5760
22	48' x 120'	5760	1	5760
23	48' x 120'	5760	1	5760
24	48' x 120'	5760	1	5760
25	48' x 120'	5760	1	5760
26	48' x 120'	5760	1	5760
27	48' x 120'	5760	1	5760
28	48' x 120'	5760	1	5760
29	48' x 120'	5760	1	5760
30	48' x 120'	5760	1	5760
31	48' x 120'	5760	1	5760
32	48' x 120'	5760	1	5760
33	48' x 120'	5760	1	5760
34	48' x 120'	5760	1	5760
35	48' x 120'	5760	1	5760
36	48' x 120'	5760	1	5760
37	48' x 120'	5760	1	5760
38	48' x 120'	5760	1	5760
39	48' x 120'	5760	1	5760
40	48' x 120'	5760	1	5760
41	48' x 120'	5760	1	5760
42	48' x 120'	5760	1	5760
43	48' x 120'	5760	1	5760
44	48' x 120'	5760	1	5760
45	48' x 120'	5760	1	5760
46	48' x 120'	5760	1	5760
47	48' x 120'	5760	1	5760
48	48' x 120'	5760	1	5760
49	48' x 120'	5760	1	5760
50	48' x 120'	5760	1	5760
51	48' x 120'	5760	1	5760
52	48' x 120'	5760	1	5760
53	48' x 120'	5760	1	5760
54	48' x 120'	5760	1	5760
55	48' x 120'	5760	1	5760
56	48' x 120'	5760	1	5760
57	48' x 120'	5760	1	5760
58	48' x 120'	5760	1	5760
59	48' x 120'	5760	1	5760
60	48' x 120'	5760	1	5760
61	48' x 120'	5760	1	5760
62	48' x 120'	5760	1	5760
63	48' x 120'	5760	1	5760
64	48' x 120'	5760	1	5760
65	48' x 120'	5760	1	5760
66	48' x 120'	5760	1	5760
67	48' x 120'	5760	1	5760
68	48' x 120'	5760	1	5760
69	48' x 120'	5760	1	5760
70	48' x 120'	5760	1	5760
71	48' x 120'	5760	1	5760
72	48' x 120'	5760	1	5760
73	48' x 120'	5760	1	5760
74	48' x 120'	5760	1	5760
75	48' x 120'	5760	1	5760
76	48' x 120'	5760	1	5760
77	48' x 120'	5760	1	5760
78	48' x 120'	5760	1	5760
79	48' x 120'	5760	1	5760
80	48' x 120'	5760	1	5760
81	48' x 120'	5760	1	5760
82	48' x 120'	5760	1	5760
83	48' x 120'	5760	1	5760
84	48' x 120'	5760	1	5760
85	48' x 120'	5760	1	5760
86	48' x 120'	5760	1	5760
87	48' x 120'	5760	1	5760
88	48' x 120'	5760	1	5760
89	48' x 120'	5760	1	5760
90	48' x 120'	5760	1	5760
91	48' x 120'	5760	1	5760
92	48' x 120'	5760	1	5760
93	48' x 120'	5760	1	5760
94	48' x 120'	5760	1	5760
95	48' x 120'	5760	1	5760
96	48' x 120'	5760	1	5760
97	48' x 120'	5760	1	5760
98	48' x 120'	5760	1	5760
99	48' x 120'	5760	1	5760
100	48' x 120'	5760	1	5760

←←← TO GOHANA
NH-352 A
FROM SONIPAT (GT Road) →→→